

### INSULATION TO HALL

Insulate sloping ceilings and walls down to dado level with c 70mm insulated plaster panels, painted internal skim finishes

### PARTITIONS & CEILING

Provide full height timber stud wall partitions with quilt sound insulation and double layer 12mm plasterboard finish.  
Provide horizontal plasterboard ceiling at 2.7m height with softwood ceiling joists

### LEVEL FLOOR (Disabled Access)

Reset floor at the end of Hall level replacing step and uneven floor sloping down towards the South gable wall. Replace with matching / reused t&g floor boarding.  
Insulate between floor joists with kingspan boards held in place with sw battens and ensure that underfloor ventilation is maintained

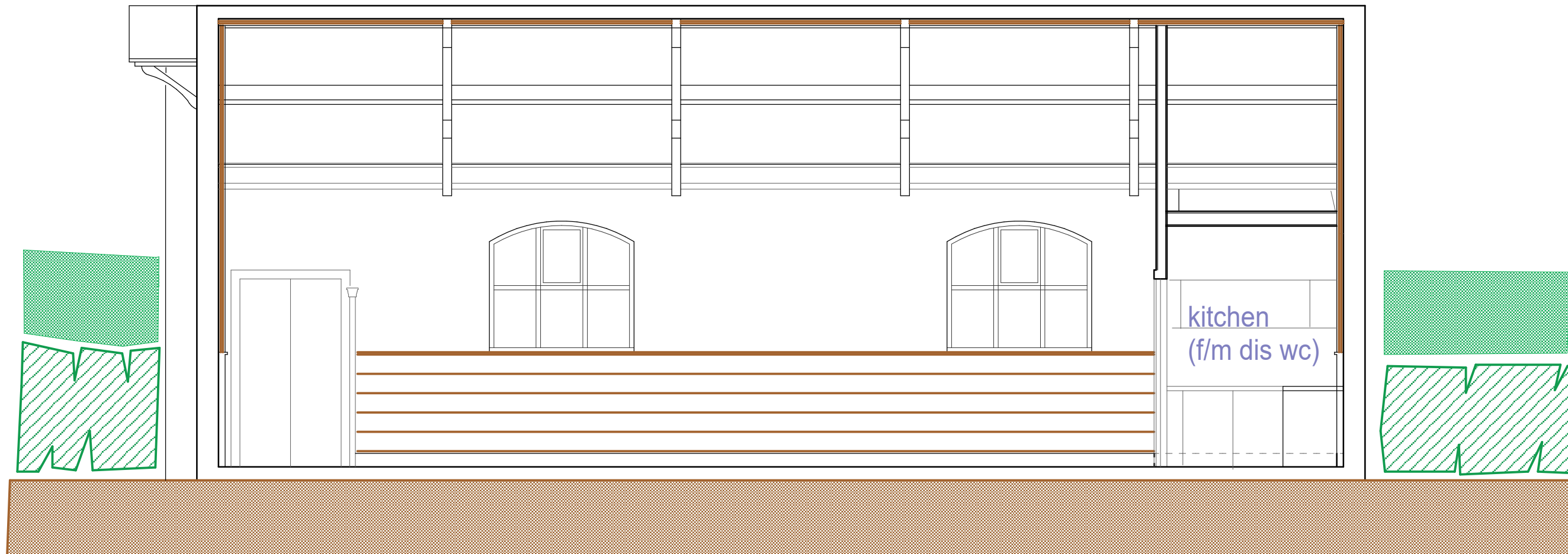

SECTION ~ NORTH-SOUTH



Mission Heritage Centre - The Lane - Sunderland Point

3 WAIVERVIEW ~  
LANCASTER ~ LA1 4J6  
TEL 01524 381555  
mel@t-a-architects.co.uk

Thomas Associates Architects

MISSION  
HERITAGE  
CENTRE

Scale  
SECTION E-W  
1:50 (A3)

Date  
DEC 2021

DWG No.  
2635 / 07